

2D REFERENCE SIZE(UNIT:mm)

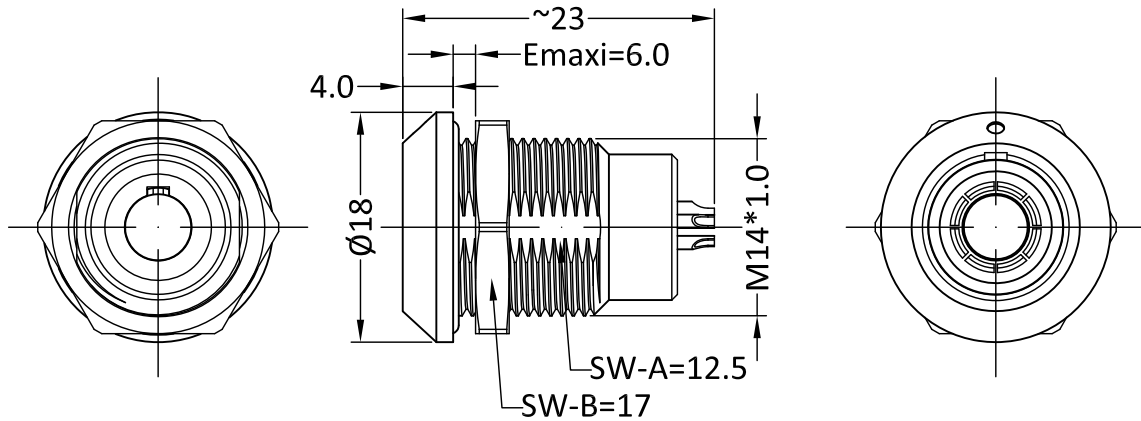

- Housing Material: Brass pearled chrome
- Insulator Material: PPS
- Contact Material: Copper alloy
- Mating cycle: 5000 times(IEC 60512 test 9a)
- IP Rating: IP68。(IEC 60529)
- Humidity (max): <=95%[at 60°C]
- Temp (min/max): -55°C~+125°C(GB/T2423.3)
- Vibration: 10-2000Hz, 15g(IEC 60512-4 test 6d)
- Shock Resistance: 100g, 6ms(IEC 60512-4 test 6c)
- Salt Spray Corrosion: >96h(IEC 60512-6 test 11f)

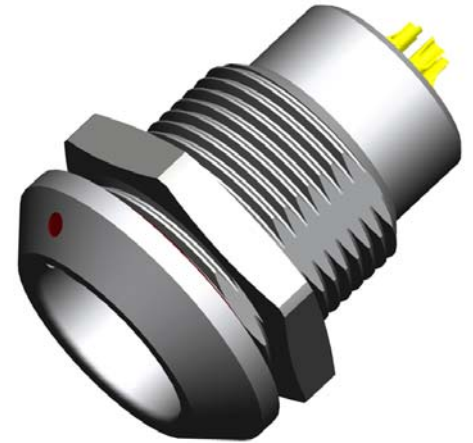

Images is for illustrative purpose only

### PART NUMBERING SYSTEM:

#### FIXED SOCKET

**SQ**G • **0**K**3**0**9** • **C**P\*

#### MODEL

##### KEY:

G=0°; A=30°;  
B=60°; C=90°; ...

#### SERIES

CONTACTS:3=MULTICORE;  
09=9PINS (2~9PINS OPTIONAL)

#### HOUSING:

C=BRASS PEARLED CHROME;  
K=BRASS PLATED BLACK CHROME;  
T=ALUMINIUM ALLOY PLATED NICKEL





#### INSULATOR:

P=PPS;K=PEEK;

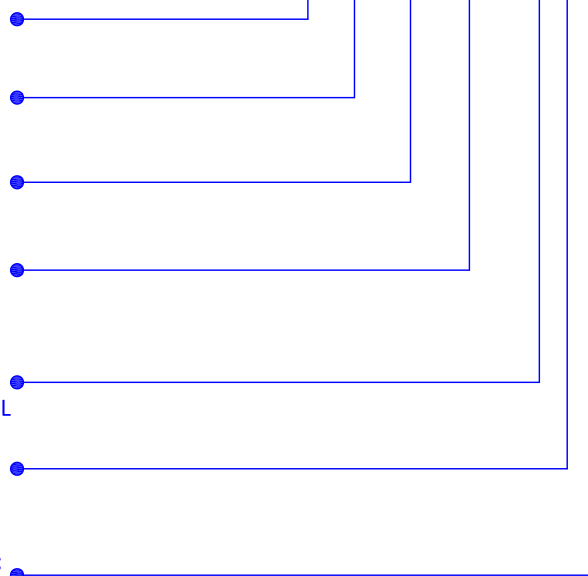
#### CONTACTS TYPE:

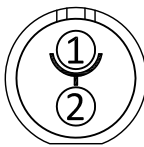
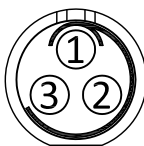
A=MALE SOLDER ;L:FEMALE SOLDER;  
D=PCB-MALE ;N=PCB-FEMALE;  
V=PCB- FEMALE ELBOW

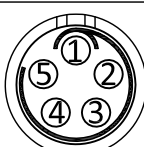
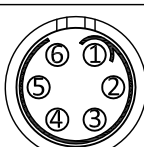

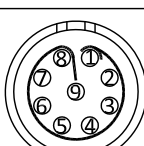
P/N	CORE	TYPE	PIN DIA (mm)	WORK VOLTAGE (KV rms)			CONTACT RESISTANCE (mΩ)	CABLE (AWG)	
				CONTACTS-CONTACTS	CONTACTS-SHELL			min.	max.
SQG.0K302.CP*	2		0.9	1.05	1.35	10	6	32	20
SQG.0K303.CP*	3		0.9	1.2	0.9	8	6	32	20
SQG.0K304.CP*	4		0.7	0.85	0.7	7	7.5	32	22
SQG.0K305.CP*	5		0.7	1.0	0.7	6.5	7.5	32	22
SQG.0K306.CP*	6		0.5	0.85	0.65	2.5	10	32	28
SQG.0K307.CP*	7		0.5	0.8	0.7	2.5	10	32	28
SQG.0K309.CP*	9		0.5	0.6	0.5	2.0	10	32	28

NOTE: SOCKET WITH ELBOW(90°)CONTACT FOR PRINTED CIRCUIT, RATED CURRENT:6A

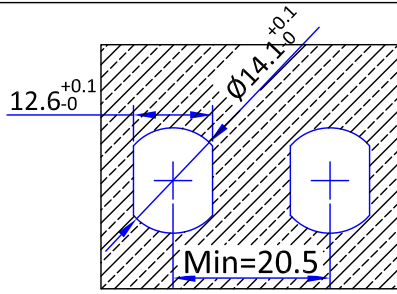

SERIES PANEL HOLES SIZE

PCB OPEN SIZE(STRAIGHT)		PCB OPEN SIZE(ELBOW)	
			<b>02</b>
	<b>03</b>		<b>04</b>
	<b>05</b>		<b>06</b>
	<b>07</b>		<b>09</b>