

2D REFERENCE SIZE(UNIT:mm)

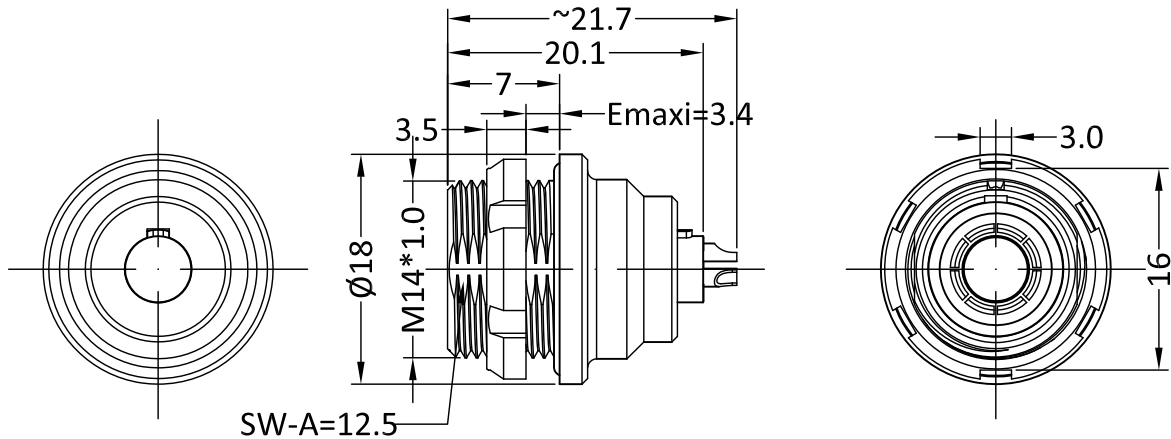

- Housing Material: Brass pearled chrome
- Insulator Material: PPS
- Contact Material: Copper alloy
- Mating cycle: 5000 times(IEC 60512 test 9a)
- IP Rating: IP68。(IEC 60529)
- Humidity (max): <=95%[at 60°C]
- Temp (min/max): -55°C~+125°C(GB/T2423.3)
- Vibration: 10-2000Hz, 15g(IEC 60512-4 test 6d)
- Shock Resistance: 100g, 6ms(IEC 60512-4 test 6c)
- Salt Spray Corrosion: >96h(IEC 60512-6 test 11f)

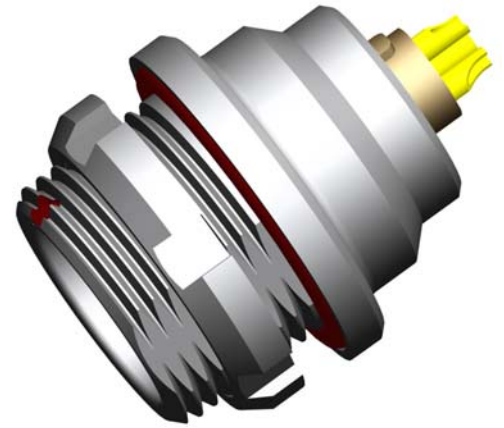

Images is for illustrative purpose only

PART NUMBERING SYSTEM:

FIXED SOCKET

SEG • 0K309 • CP *

MODEL

KEY:

G=0°; A=30°;
B=60°; C=90°; ...

SERIES

CONTACTS:3=MULTICORE;
09=9PINS (2~9PINS OPTIONAL)

HOUSING:

C=BRASS PEARLED CHROME;
K=BRASS PLATED BLACK CHROME;
T=ALUMINIUM ALLOY PLATED NICKEL

INSULATOR:



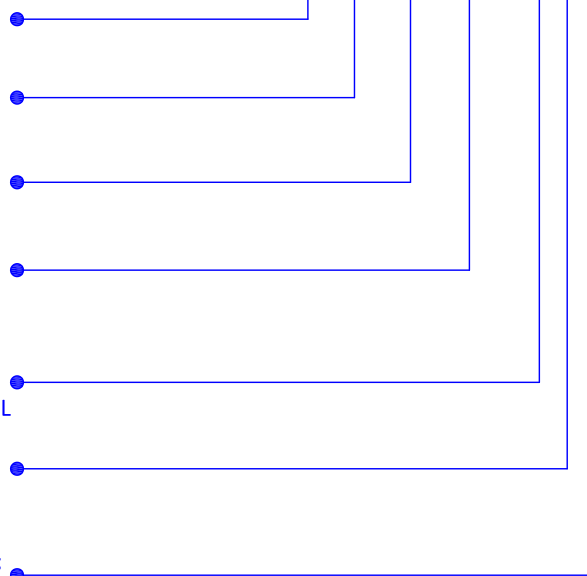

P=PPS;K=PEEK;

CONTACTS TYPE:

A=MALE SOLDER ;L:FEMALE SOLDER;
D=PCB-MALE ;N=PCB-FEMALE;
V=PCB- FEMALE ELBOW

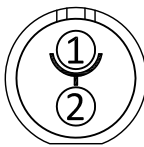
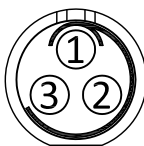

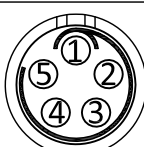
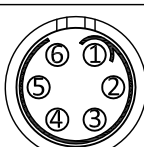
*=Customers can choose the model according to their own needs

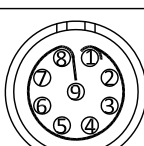
P/N	CORE	TYPE	PIN DIA (mm)	WORK VOLTAGE (KV rms)		RATED CURRENT (A)	CONTACT RESISTANCE (mΩ)	CABLE (AWG)	
				CONTACTS-CONTACTS	CONTACTS-SHELL			min.	max.
SEG.0K302.CP*	2		0.9	1.05	1.35	10	6	32	20
SEG.0K303.CP*	3		0.9	1.2	0.9	8	6	32	20
SEG.0K304.CP*	4		0.7	0.85	0.7	7	7.5	32	22
SEG.0K305.CP*	5		0.7	1.0	0.7	6.5	7.5	32	22
SEG.0K306.CP*	6		0.5	0.85	0.65	2.5	10	32	28
SEG.0K307.CP*	7		0.5	0.8	0.7	2.5	10	32	28
SEG.0K309.CP*	9		0.5	0.6	0.5	2.0	10	32	28

*=Customers can choose the model according to their own needs

NOTE: SOCKET WITH ELBOW(90°)CONTACT FOR PRINTED CIRCUIT, RATED CURRENT:6A

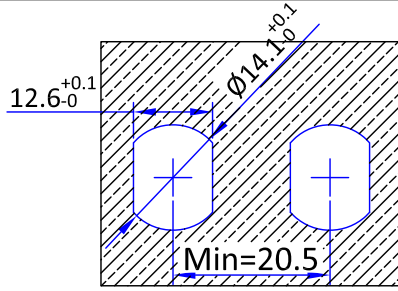

SERIES PANEL HOLES SIZE

PCB OPEN SIZE(STRAIGHT)		PCB OPEN SIZE(ELBOW)	
			02
	03		04
	05		06
	07		09